

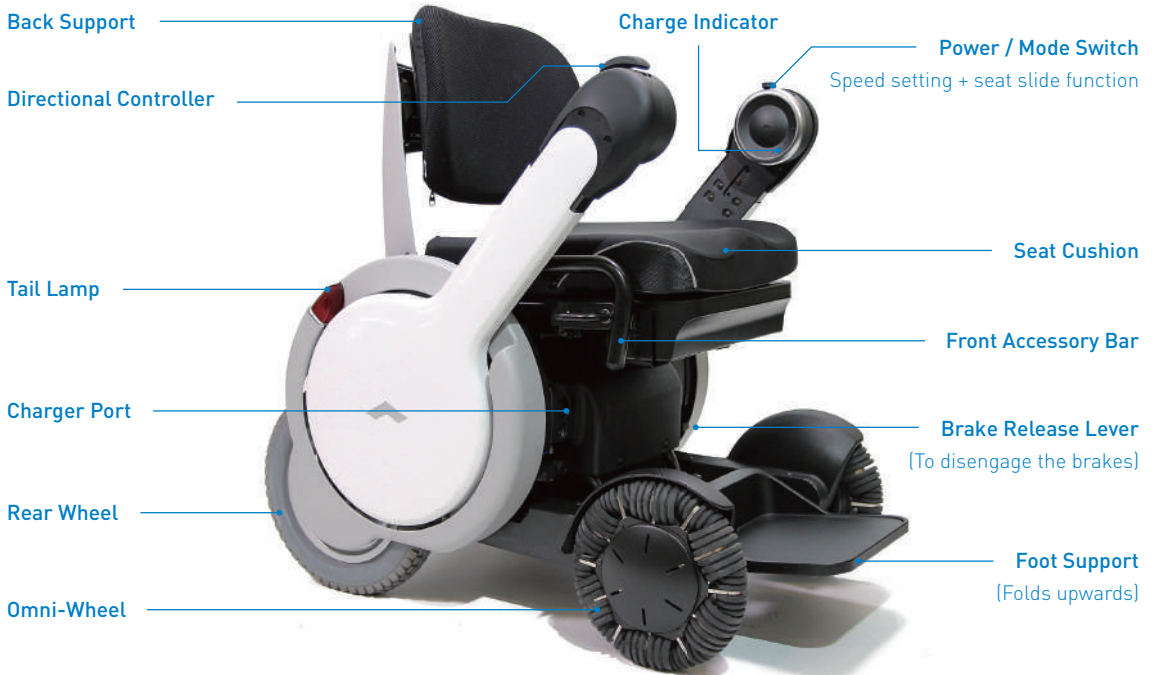

WHILL

Model A Quick Start Guide

Refer to User Manual for complete instructions and important safety information



What's Included:



WHILL Model A



Model A User Manual



Battery Charger



Alternate controller: Easygrip



Foot-rest lengthening spacers

Driving Your WHILL Model A

1



Make sure brakes
are engaged

Brake levers should be fully horizontal

2



Sit in the Model A

arms and footrest swing up and down
For easy access

3



To power on the device, pull
back switch to  and release

Indicator lights are blue when the device is on

4

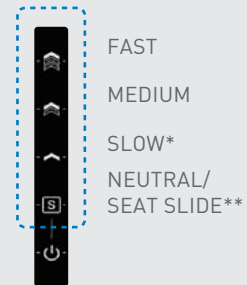

Select speed setting

*always start in slow speed

**seat slide functionality is described on the next page

5



Use controller to steer
& accelerate the Model A

6

EXIT = 

When exiting the chair, make sure
the indicator switch is on  mode

Note: the brakes are automatically
engaged when chair is not moving

How to Use Power Seat Slide



NOTE:

If the seat is in the forward position, the WHILL logo will be flashing and you must fully retract the seat before the device is able to move.

iPhone App

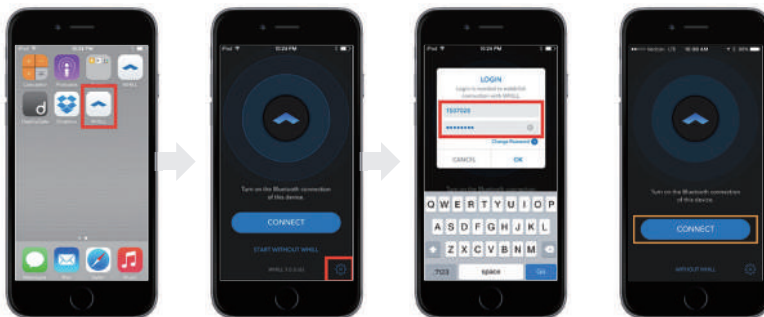

1. Download the whill app from the Apple app store
2. Make sure Bluetooth is turned "on" on the iPhone (This is how the iPhone connects to the Model A)
3. Open the app, in the bottom right corner, press "settings" button
4. Your device ID can be found on the back of the Model A
5. The default password is: 00000000 (8 zeros)
6. Press connect, then start driving remotely, or configure the speed settings



Charging Your WHILL Model A



Indicator lights on the charger

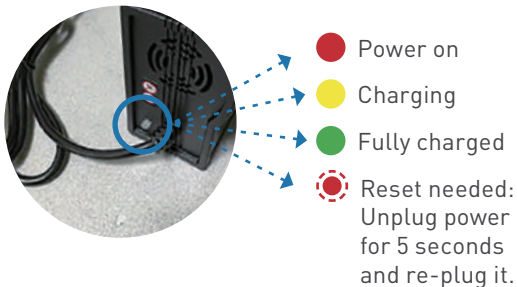

Battery indicator lights on the Model A:

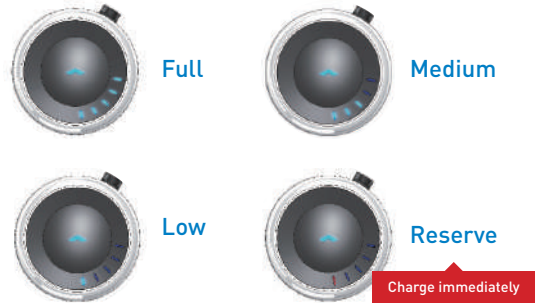

To Manually Move the Model A



Use the brake release levers to release the brakes and manually move the Model A when it's out of charge or otherwise inoperable



Common Issues While Operating the Model A

Common errors are indicated by different light combinations on the charge indicator as described below:

Error as viewed on the indicator

Explanation & Resolution



Flashing WHILL LED logo

The driving capability has been disabled due to the **seat in the forward position**. To resolve, place the **power/ mode switch in the  position and retract the seat all the way backward**. The WHILL logo will stop blinking.



Flashing red LED 1

The user tried powering on the device while it's **charging**. To resolve, **unplug the round connector from the charger port on the Model A and turn device on**.



Alternate flashing red LED 1 & blue LED 2

The user tried powering on the device with the **brakes released**. To resolve, **engage both brakes by pushing both brake levers up (horizontal position) and turn the device on**.



Alternate flashing red LED 1 & blue LED 3

The user tried powering on the device with the **controller arm in the high position**. To resolve, **lower the controller arm completely to its locked position and turn device on**.



Alternate flashing red LED 1 & blue LED 1

The user tried powering on the device while **moving directional controller**. To resolve, **do not move the directional controller when powering on Model A**.

Should you encounter and other technical issues, please contact support@whill.us or call us at (844)699-4455

The WHILL Model A is not considered a medical device and has not been submitted to the Food and Drug Administration for review or clearance.



WHILL